

# Ring Main Systems

The unique aluminium tubing used in Infinity pipework and it's huge range of connection options



## 90000

TUBES BLUE - 4MTR

Code	Outside Ø mm	Thickness mm	Pressure bar	Weight gr/m	Length 4 Mt.	Pack.
90000-20	20	1.5	16	235	4 m	8
90000-25	25	1.5	16	298	4 m	8
90000-32	32	1.5	16	387	4 m	9
90000-40	40	1.5	16	490	4 m	9
90000-50	50	2	16	814	4 m	4
90000-63	63	2	16	1034	4 m	4
90000-80	80	2	16	1493	4 m	2
90000-110	110	2.5	16	2280	4 m	2



## 90000GR

TUBES GREY - 4MTR

Code	Outside Ø mm	Thickness mm	Pressure bar	Weight gr/m	Length 4 Mt.	Pack.
90000GR-20	20	1.5	16	235	4 m	8
90000GR-25	25	1.5	16	298	4 m	8
90000GR-32	32	1.5	16	387	4 m	9
90000GR-40	40	1.5	16	490	4 m	9
90000GR-50	50	2	16	814	4 m	4
90000GR-63	63	2	16	1034	4 m	4
90000GR-80	80	2	16	1493	4 m	2
90000GR-110	110	2.5	16	2280	4 m	2



## 9000060

TUBES BLUE - 6MTR

Code	Outside Ø mm	Thickness mm	Pressure bar	Weight gr/m	Length 6 Mt.	Pack.
9000060-20	20	1.5	16	235	6 m	8
9000060-25	25	1.5	16	298	6 m	8
9000060-32	32	1.5	16	387	6 m	9
9000060-40	40	1.5	16	490	6 m	4
9000060-50	50	2	16	814	6 m	4
9000060-63	63	2	16	1034	6 m	2
9000060-80	80	2	16	1493	6 m	2
9000060-110	110	2.5	16	2280	6 m	1



## 9000060GR

TUBES GREY - 6MTR

Code	Outside Ø mm	Thickness mm	Pressure bar	Weight gr/m	Length 6 Mt.	Pack.
9000060GR-20	20	1.5	16	235	6 m	8
9000060GR-25	25	1.5	16	298	6 m	8
9000060GR-32	32	1.5	16	387	6 m	9
9000060GR-40	40	1.5	16	490	6 m	4
9000060GR-50	50	2	16	814	6 m	4
9000060GR-63	63	2	16	1034	6 m	2
9000060GR-80	80	2	16	1493	6 m	2
9000060GR-110	110	2.5	16	2280	6 m	1

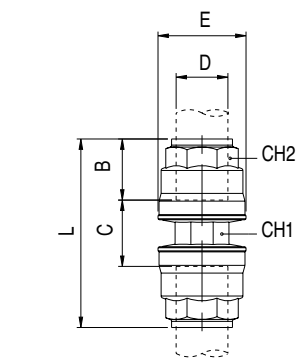
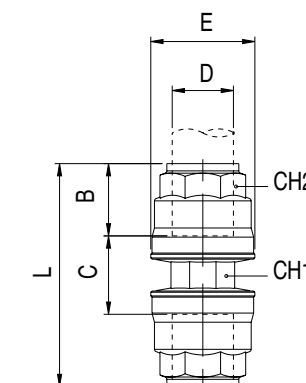
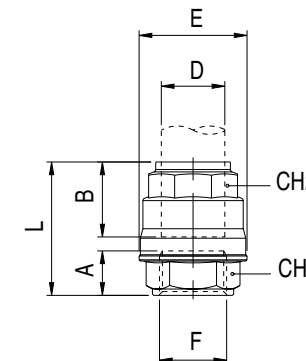
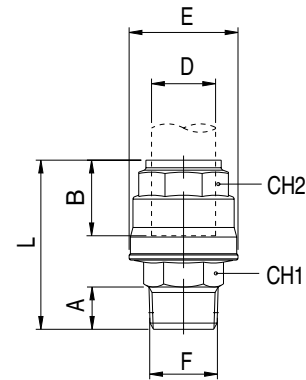
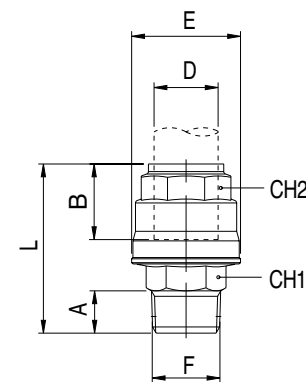

## 90010

STRAIGHT MALE ADAPTOR

Code	D	F	A	B	E	L	CH1	CH2	Pack.
90010-20-1/2	20	1/2	14	31.5	34.5	56	22	30	10
90010-20-3/4	20	3/4	16.5	31.5	34.5	61	22	30	10
90010-25-3/4	25	3/4	16.5	38.5	42.5	66	27	35	5
90010-25-1	25	1"	19	38.5	42.5	70.5	27	35	5
90010-32-1	32	1"	19	46	52	76.5	34	45	2
90010-40-1-1/4	40	1"1/4	21.5	52	63	89.5	45	55	2
90010-40-1-1/2	40	1"1/2	21.5	52	63	92	50	55	2
90010-50-1-1/2	50	1"1/2	21.5	63.5	73	105	50	65	2

## 90010A

STRAIGHT MALE ADAPTOR - 63MM ALUMINIUM

Code	D	F	A	B	E	L	CH1	CH2	Pack.
90010A-63-2	63	2"	24	57.5	94	109.5	65	75	2
90010A-63-2-1/2	63	2"1/2	24	57.5	94	106.5	75	75	2

## 90030

STRAIGHT FEMALE ADAPTOR

Code	D	F	A	B	E	L	CH1	CH2	Pack.
90030-20-1/2	20	1/2	15	31.5	34.5	49	24	30	10
90030-25-3/4	25	3/4	16.5	38.5	42.5	56.5	32	35	5
90030-32-1	32	1"	19	46	52	66.5	38	45	2
90030-40-1-1/4	40	1"1/4	22	52	63	76	50	55	2
90030-50-1-1/2	50	1"1/2	22	63.5	73	85.5	55	65	2

## 90040

STRAIGHT CONNECTOR

Code	D	B	C	E	L	CH1	CH2	Pack.
90040-20	20	31.5	14.5	34.5	76.5	21	30	5
90040-25	25	38.5	13.5	42.5	90.5	26	35	5
90040-32	32	46	14.5	52	106.5	32	45	2
90040-40	40	52	21	63	125	41	55	2
90040-50	50	63.5	21.5	73	148.5	50	65	2

## 90040A

STRAIGHT CONNECTOR - 63MM ALUMINIUM

Code	D	B	C	E	L	CH1	CH2	Pack.
90040A-63	63	57.5	44	94	159	73	75	1

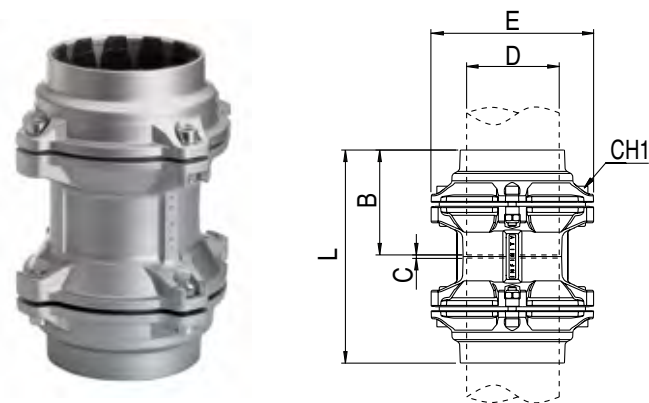

## 90040-80-110

STRAIGHT CONNECTOR - 80MM / 110MM

Code	D	B	C	E	L	CH1	Pack.
90040-80	80	91	3.5	145	186	6	1
90040-110	110	125.5	4	200	255	8	1



## 90019

FLANGE KIT

Code	SIZE	Pack.
90019-110	M16 65 mm	1

KIT: 8 SCREW + 8 NUT + 16 WASHER

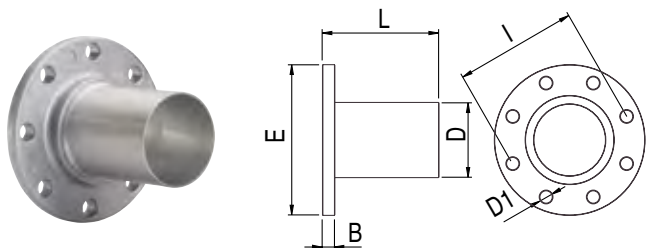

## 90015

FLANGED TUBE

Code	D	B	E	L	DI	I	Pack.
90015-80	80	20	200	155	18	160	1
90015-110	110	20	220	183	18	180	1

The connection dimensions of the flange are designed in conformity with standard UNI EN 1092 - 4 PN 16 (Flange made in aluminium alloy).

## Installation 90015

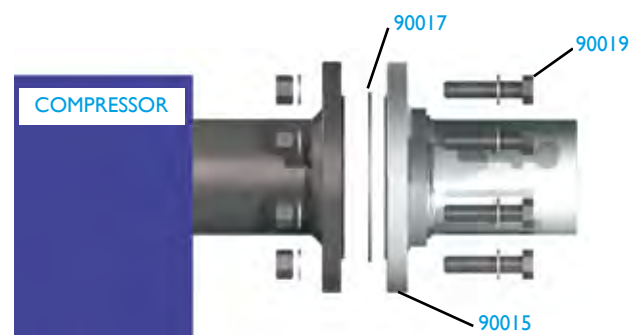

Lay flange gasket item 90017 between compressor flange and item 90015. Tighten the eight screws item 90019. Tightening torque 60 Nm.



See right-hand side picture for final assembly.

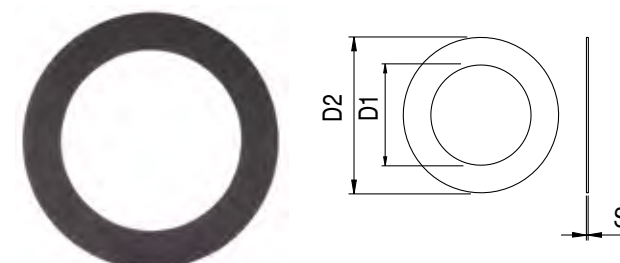

## 90017

FLAT GASKET FOR FLANGE

Code	D	DI	D2	S	Pack.
90017-80	80	89	131	2	1
90017-110	110	105	162	2	1

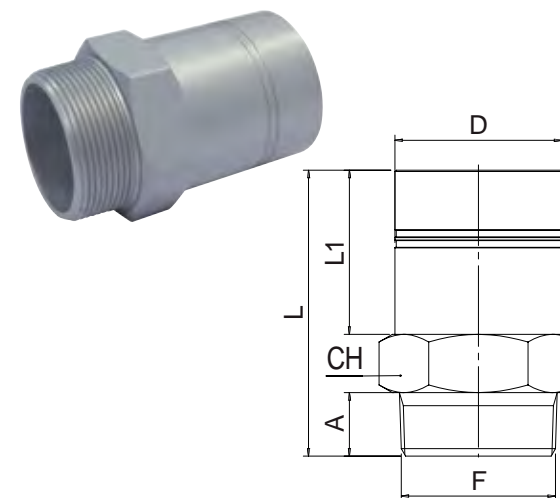

## 90627A

MALE STEM ADAPTOR

Code	D	F	A	L	LI	CH	Pack.
90627A-63-2	63	2"	24	108	62	65	2

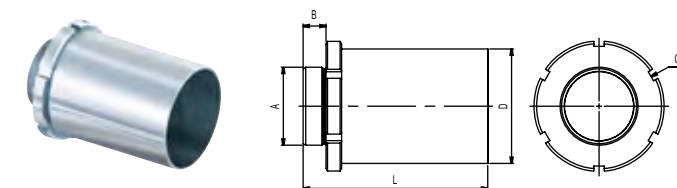

## 90020

TUBE

Code	D	A	B	L	CH	Pack.
90020-80-2-1/2	80	2"-1/2	22	143	*100	1
90020-80-3	80	3"	23	144	*100	1
90020-110-212	110	2"-1/2	22	178	*125	1
90020-110-3	110	3"	23	179	*125	1

\*HOOK WRENCH DIMENSIONS

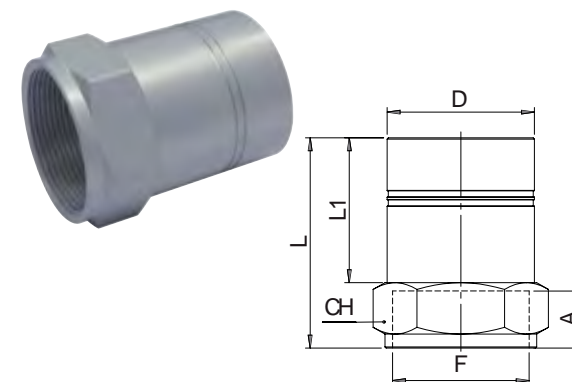

## 90625A

FEMALE STEM ADAPTOR

Code	D	F	A	L	LI	CH	Pack.
90625A-63-1-1/2	63	1"-1/2	20	84	62	65	2
90625A-63-2	63	2"	22	90	62	65	2

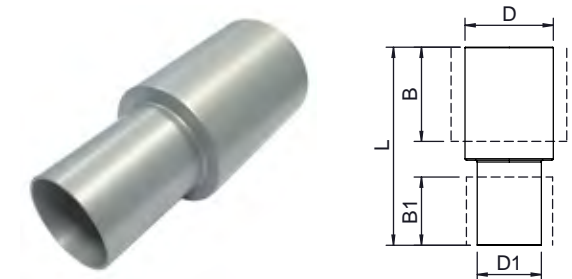

## 90012

TUBE-TUBE REDUCER

Code	D	DI	B	BI	L
90012-110-80	110	80	150.5	91	247
90012-80-63	80	63	91	57.5	168

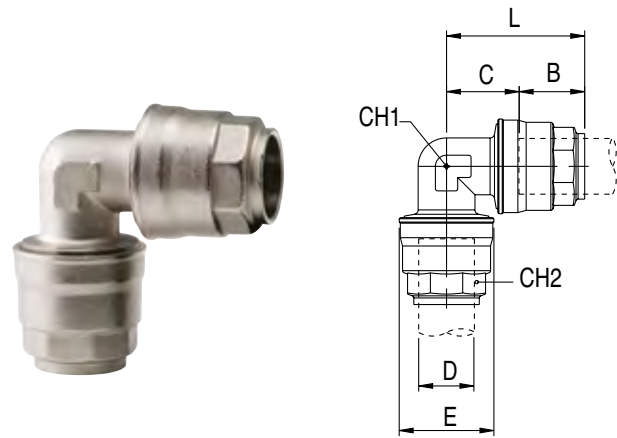

## 90130

90 ELBOW CONNECTOR

Code	D	B	C	E	L	CH1	CH2	Pack.
90130-20	20	31.5	19	34.5	51	21	30	4
90130-25	25	38.5	23	42.5	61.5	26	35	4
90130-32	32	46	28	52	74.5	34	45	2
90130-40	40	52	34	63	86.5	41	55	2
90130-50	50	63.5	40.5	73	104	50	65	2

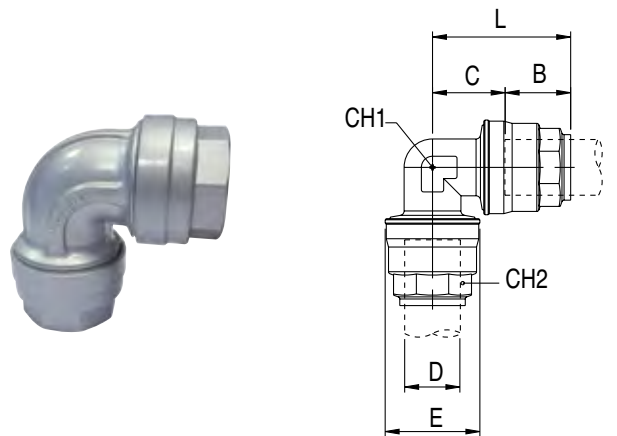

## 90130A 63

90 ELBOW CONNECTOR - 63MM ALUMINIUM

Code	D	B	C	E	L	CH1	CH2	Pack.
90130A-63	63	57.5	55.5	94	113	73	75	1

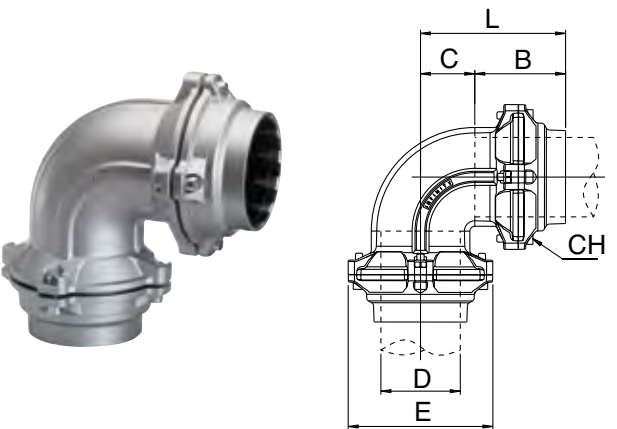

## 90130

90 ELBOW CONNECTOR - 80MM / 110MM

Code	D	B	C	E	L	CH	Pack.
90130-80	80	91	54.5	145	146	6	1
90130-110	110	125.5	75	200	200.5	8	1

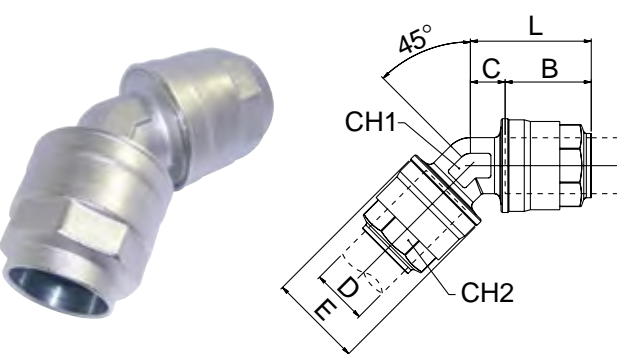

## 90140

45 ELBOW CONNECTOR

Code	D	B	C	E	L	CH1	CH2	Pack.
90140-20	20	31.5	12.5	34.5	44	21	30	4
90140-25	25	38.5	13.5	42.5	52	26	35	4
90140-32	32	46	15	52	61	34	45	2
90140-40	40	52	18	63	70	41	55	2
90140-50	50	63.5	20	73	83.5	50	65	2
90140A-63	63	59	24	92	83	65	70	1

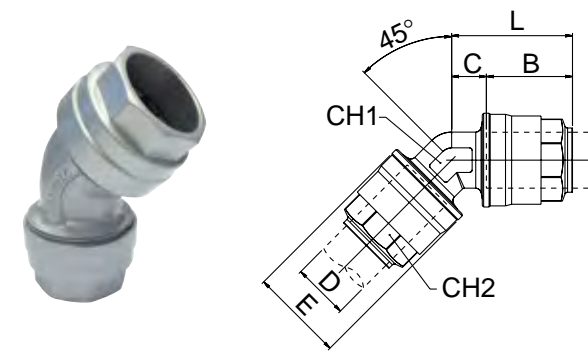

## 90140A-63

45 ELBOW CONNECTOR - 63MM ALUMINIUM

Code	D	B	C	E	L	CH1	CH2	Pack.
90140A-63	63	57.5	24	94	82	73	75	1

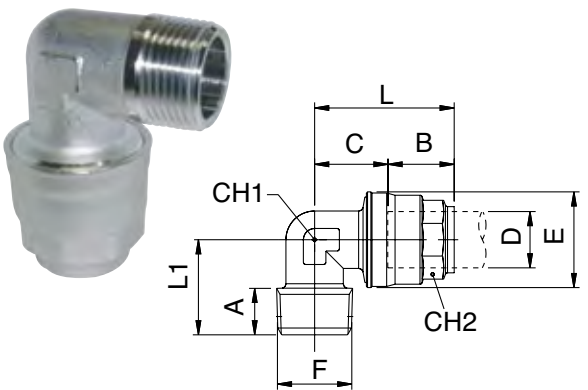

## 90150

ELBOW CONNECTOR - MALE BSP

Code	D	F	A	B	C	E	L	L1	CH1	CH2	Pack.
90150-20-1/2	20	1/2	14	31.5	19	34.5	51	32	21	30	4
90150-25-3/4	25	3/4	16.5	38.5	23	42.5	61.5	37	26	35	4
90150-32-1	32	1"	19	46	28	52	74.5	49	34	45	2
90150-40-1-1/4	40	1"-1/4	21.5	52	34	63	86.5	54	41	55	2
90150-50-1-1/2	50	1"-1/2	21.5	63.5	40.5	73	104	59	50	65	2
90150-63-2	63	2"	24	59	52	92	111	71	65	70	1

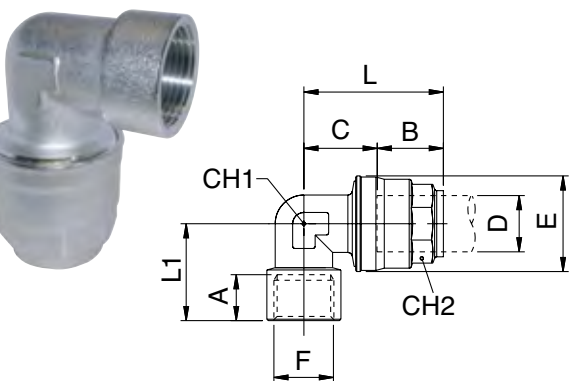

## 90160

ELBOW CONNECTOR - FEMALE BSP

Code	D	F	A	B	C	E	L	L1	CH1	CH2	Pack.
90160-20-1/2	20	1/2	13	31.5	19	34.5	51	34.5	21	30	4
90160-25-3/4	25	3/4	14.5	38.5	23	42.5	61.5	38.5	26	35	4
90160-32-1	32	1"	16.5	46	28	52	74.5	47.5	34	45	2
90160-40-1-1/4	40	1"-1/4	20	52	34	63	86.5	56.5	41	55	2
90160-50-1-1/2	50	1"-1/2	22	63.5	40.5	73	104	64.7	50	65	2
90160-63-2	63	2"	21.7	59	52	92	111	77	65	70	1

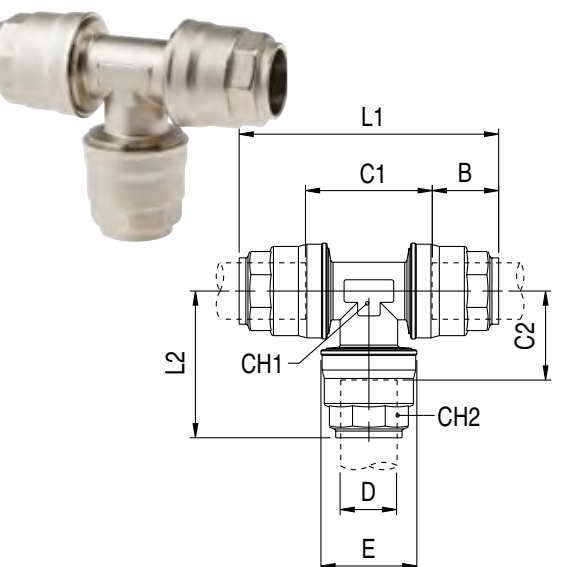

## 90230

TEE CONNECTOR

Code	D	E	B	C1	C2	L1	L2	CH1	CH2	Pack.
90230-20	20	34.5	31.5	34.5	22.5	98	54.5	21	30	3
90230-25	25	42.5	38.5	37.5	26	113.5	65	26	35	3
90230-32	32	52	46	46.5	31.5	138.5	77	34	45	2
90230-40	40	63	52	55.5	38	159.5	90	41	55	1
90230-50	50	73	63.5	69	44.5	196	108	50	65	1
90230A-63	63	92	59	87	55.5	205.5	114.5	65	70	1



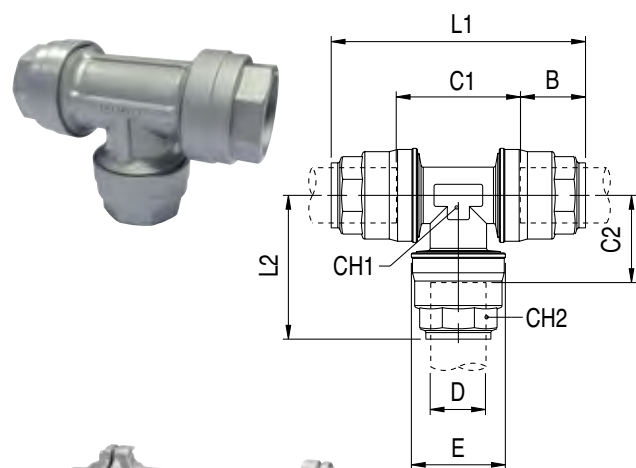

## 90230A-63

TEE CONNECTOR - 63MM ALUMINIUM

Code	D	E	B	C1	C2	L1	L2	CH1	CH2	Pack.
90230A-63	63	94	57.5	111	55.5	226	113	73	75	1

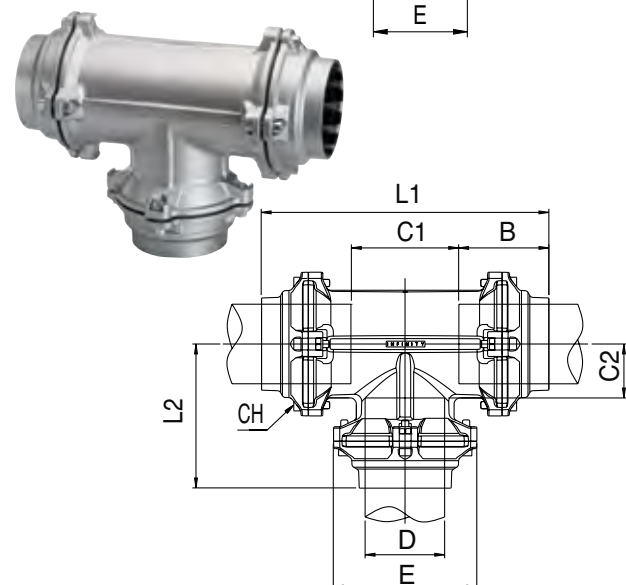

## 90230

TEE CONNECTOR - 80MM / 110MM

Code	D	E	B	C1	C2	L1	L2	CH	Pack.
90230-80	80	145	91	109	54.5	291.5	138	6	1
90230-110	110	200	125.5	150.5	75	401	200.5	8	1

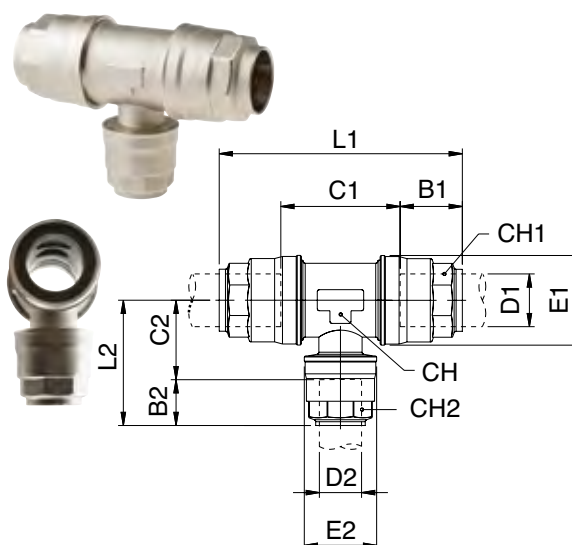

## 90235

REDUCING TEE C/W WATER TRAP

Code	D1	D2	B1	B2	C1	C2	E1	E2	L1	L2	CH	CH1	CH2	Pack.
90235-20-20	20	20	31.5	31.5	48	22.5	34.5	34.5	109	54	28	30	30	3
90235-25-20	25	20	38	31.5	45.5	27.5	42.5	34.5	121.5	59	35	35	30	3
90235-32-20	32	20	46	31.5	54.5	31.5	52	34.5	146.5	63	45	45	30	2
90235-32-25	32	25	46	38	54.5	31.5	52	42.5	146.5	70	45	45	35	2
90235-40-20	40	20	52.5	31.5	60	34.5	63	34.5	165.5	66	55	55	30	2
90235-40-25	40	25	52.5	38	60	34.5	63	42.5	165.5	73	55	55	35	2
90235-50-20	50	20	63.5	31.5	73.5	41.5	73	34.5	201	73	65	65	30	1
90235-50-25	50	25	63.5	38.5	73.5	41	73	42.5	201	80	65	65	35	1
90235-50-32	50	32	63.5	46	73.5	41	73	52	201	87.5	65	65	45	1
90235-63-20	63	20	59	31.5	86	49.5	92	34.5	204.5	81	80	70	30	1
90235-63-25	63	25	59	38.5	86	49	92	42.5	204.5	88	80	70	35	1
90235-63-32	63	32	59	46	86	49	92	52	204.5	95.5	80	70	45	1

## 90236

REDUCING TEE C/W WATER TRAP - BSP FEMALE

Code	D	F	A	B	C	E	L1	L2	CH	CH1	Pack.
90236-20-3/8	20	3/8	11	31.5	48	34.5	109	25	28	30	3
90236-20-1/2	20	1/2	13.5	31.5	48	34.5	109	28	28	30	3
90236-25-3/8	25	3/8	11	38.5	45.5	42.5	121.5	29	35	35	3
90236-25-1/2	25	1/2	13.5	38.5	45.5	42.5	121.5	31	35	35	2
90236-32-1/2	32	1/2	13.5	46	54.5	52	146.5	36.5	45	45	2
90236-40-1/2	40	1/2	13.5	52.5	60	63	165.5	41.5	55	55	2
90236-50-3/4	50	3/4	14.5	63.5	73.5	73	201	47.5	65	65	1
90236-63-3/4	63	3/4	14.5	59	86	92	204.5	55	80	70	1

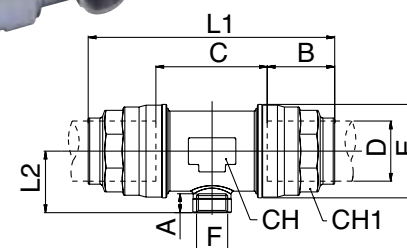
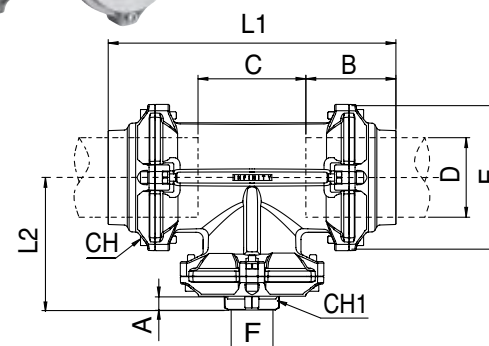
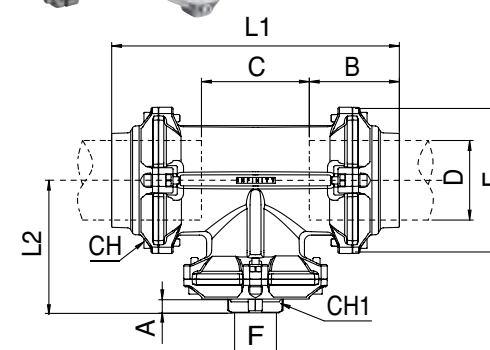
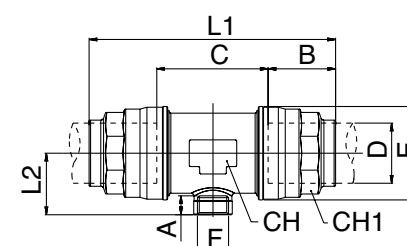

## 90236A

REDUCING TEE C/W WATER TRAP - 63MM ALUMINIUM

Code	D	F	A	B	C	E	L1	L2	CH	CH1	Pack.
90236A-63-1/2	63	1/2	13.5	57.5	88	94	203	53	80	75	1
90236A-63-3/4	63	3/4	14.5	57.5	88	94	203	54	80	75	1
90236A-63-1	63	1"	17.5	57.5	88	94	203	56.5	80	75	1

## 90236-80-110

REDUCING TEE C/W WATER TRAP - 80MM / 110MM

Code	D	F	A	B	C	E	L1	L2	CH	CH1	Pack.
90236-80-3/4	80	3/4	14.5	91	109	145	291.5	138	6	*42	1
90236-80-1	80	1"	17	91	109	145	291.5	138	6	*49	1
90236-80-1-1/2	80	1"-1/2	20	91	109	145	291.5	138	6	*66	1
90236-80-2	80	2"	22	91	109	145	291.5	138	6	*80	1
90236-110-3/4	110	3/4	14.5	125.5	150.5	200	401	180	8	*42	1
90236-110-1	110	1"	17	125.5	150.5	200	401	180	8	*49	1
90236-110-1-1/2	110	1"-1/2	20	125.5	150.5	200	401	180	8	*66	1
90236-110-2	110	2"	22	125.5	150.5	200	401	180	8	*80	1

\*HOOK WRENCH DIMENSIONS

## 90250

REDUCING TEE - BSP FEMALE

Code	D	F	A	B	C	E	L1	L2	CH	CH1	Pack.
90250-80-3/4	80	3/4	14.5	91	109	145	291.5	138	6	*42	1
90250-110-3/4	110	3/4	14.5	125.5	150.5	200	401	180	8	*42	1

\*HOOK WRENCH DIMENSIONS

## 90250A

FEMALE FITTING WITH CONDENSE EXHAUST INCORPORATED

Code	D	F	A	B	C	E	L1	L2	CH	CH1	Pack.
90250A-63-1/2	63	1/2	13.5	57.5	88	94	203	53	80	75	1

# Function 90235 - 90236

This fitting is a valid alternative to the traditional swan-neck; it shows itself as a quicker and cost effective solution. The efficient internal system allows to the air to reach the usage points without any condensate which stays within the main circuit and than it can be drained in the most convenient point.

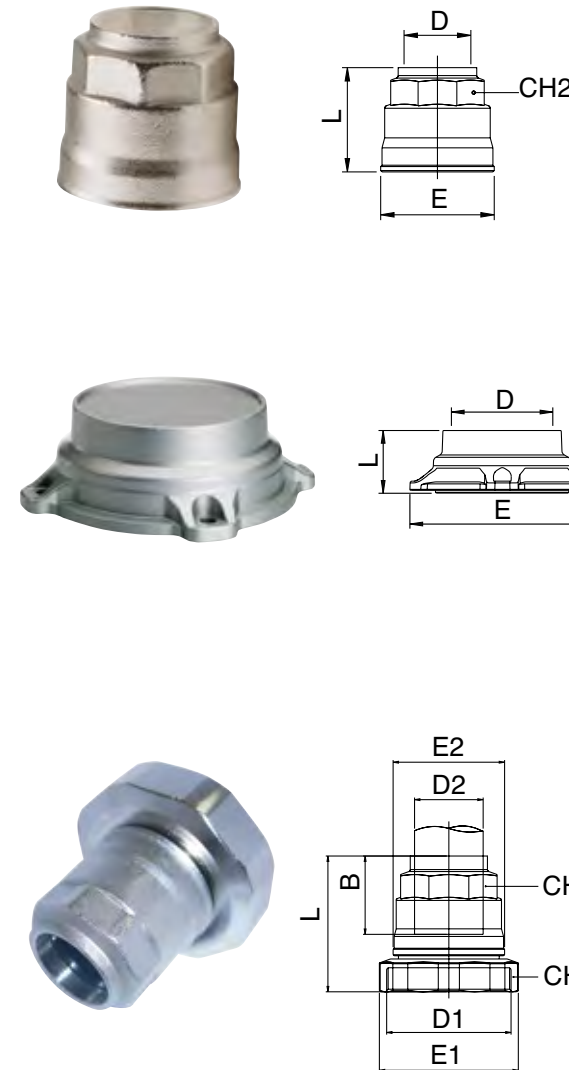
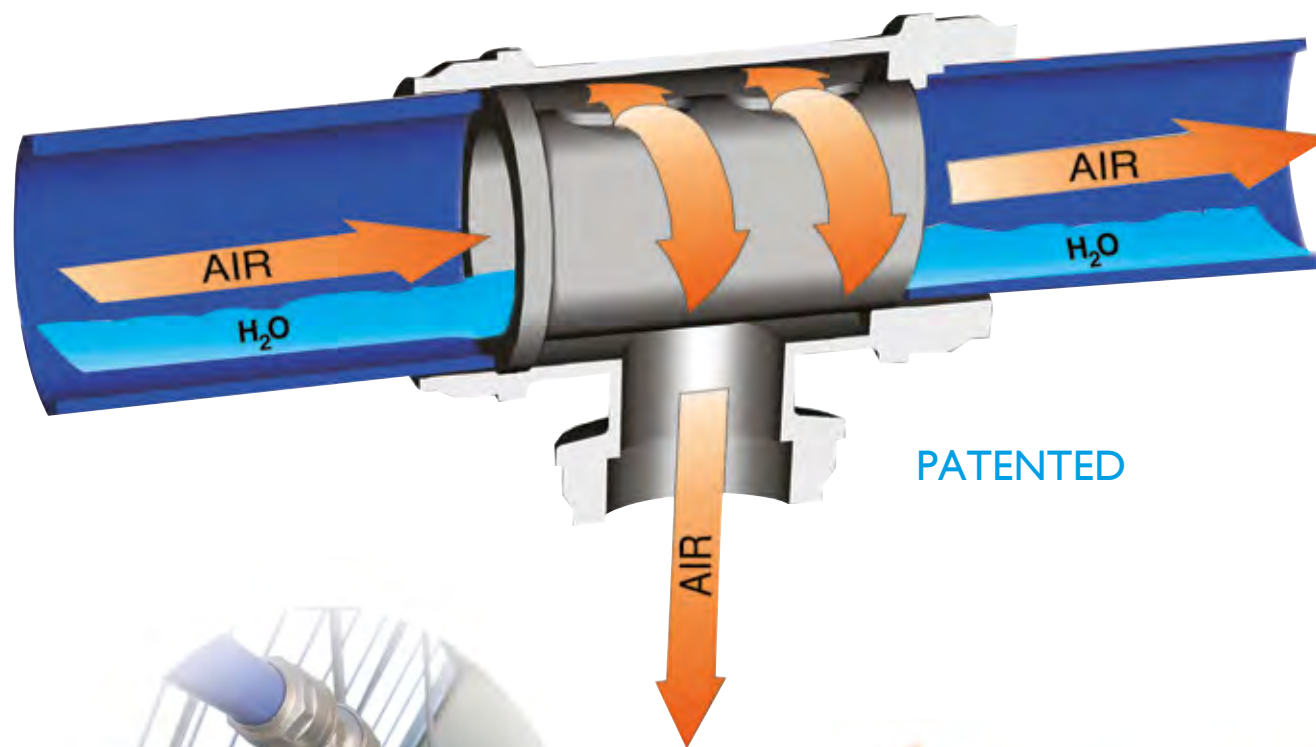
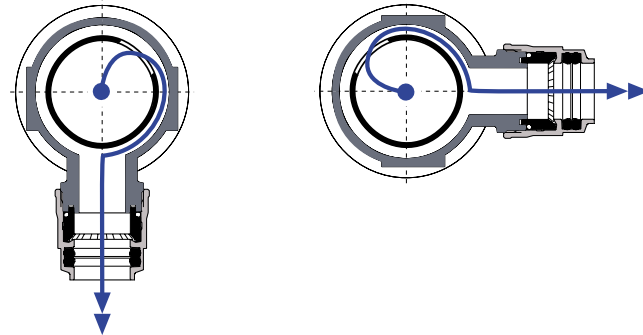

## 90610

PLUG

Code	D	L	E	CH2	Pack.
90610-20	20	33	34.5	30	10
90610-25	25	39	42.5	35	6
90610-32	32	46.5	52	45	4
90610-40	40	53	63	55	4
90610-50	50	62	73	65	2
*90610A-63	63	58	92	70	1

\*NOT INTERCHANGEABLE WITH Ø63 FITTING IN ALUMINIUM

## 90610-80-110

PLUG - 80mm / 110mm

Code	D	L	E	Pack.
90610-80	80	49.5	145	1
90610-110	110	68	200	1

## 90620

REDUCING

Code	D1	D2	B	E1	E2	L	CH1	CH2	Pack.
90620-25-20	25	20	31.5	43.5	34.5	48	42	30	5
90620-32-20	32	20	31.5	54	34.5	48.5	52	30	5
90620-32-25	32	25	38.5	54	42.5	55	63	35	5
90620-40-20	40	20	31.5	65	34.5	50	63	30	4
90620-40-25	40	25	38.5	65	42.5	56.5	63	35	4
90620-40-32	40	32	46	65	52	63.5	63	45	3
90620-50-25	50	25	38.5	75	42.5	55	73	35	1
90620-50-32	50	32	46	75	52	63.5	73	45	1
90620-50-40	50	40	52	75	63	69	73	55	1
*90620A-63-40	63	40	52	95	63	58	92	55	1
*90620A-63-50	63	50	63.5	95	73	68	92	65	1

\*NOT INTERCHANGEABLE WITH Ø63 FITTING IN ALUMINIUM



## 90630-80-110

REDUCER - 80mm / 110mm

Code	D	F	A	L	CH	Pack.
90630-80-3/4	80	3/4	14.5	42	*42	1
90630-80-1	80	1"	17	42	*49	1
90630-80-1-1/2	80	1"-1/2	20	42	*66	1
90630-80-2	80	2"	22	42	*80	1
90630-110-3/4	110	3/4	14.5	48	*42	1
90630-110-1	110	1"	17	48	*49	1
90630-110-1-1/2	110	1"-1/2	20	48	*66	1
90630-110-2	110	2"	22	48	*80	1

\*HOOK WRENCH DIMENSIONS

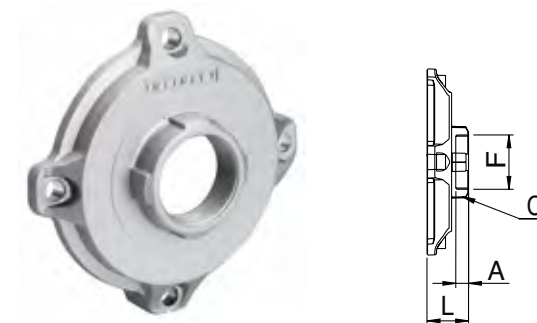



## 90700

BALL VALVE

Code	D	DN	B	C	E	L	CH1	CH2	G	H	Pack.
90700-20	20	17	31.5	58.5	34.5	121.5	32	30	88	42	6
90700-25	25	22	38.5	61.5	42.5	138.5	41	35	106	47.5	6
90700-32	32	29	46	75	52	167	50	45	106	53	2
90700-40	40	37	52.5	81	63	186	59	55	134	65	1
90700-50	50	46	63.5	103	73	230	69	65	134	72.5	1
90700A-63	63	59	59	126	92	247	92	70	240	111.5	1

FULL FLOW RATE BALL VALVE

## 90700A

BALL VALVE - 63mm ALUMINIUM

Code	D	DN	B	C	E	L	CH1	CH2	G	H	Pack.
90700A-63	63	59	57.5	38	94	232	89	75	240	111.5	1

FULL FLOW RATE BALL VALVE

## 90720

MALE-TUBE BALL VALVE

Code	D	F	DN	A	B	C	E	L	CH1	CH2	G	H	Pack.
90720-20-1/2	20	1/2	15	18	31.5	29.3	34.5	100.8	32	30	88	42	2
90720-25-3/4	25	3/4	20	18	38.5	30.8	42.5	119.3	41	35	106	47.5	2

## 90710-80-110

BUTTERFLY VALVE

Code	D	DN	A	B	C	E	F	Pack.
90710-80	80	77	87	216	46	160	210	1
90710-110	110	100	106	201	52	180	210	1

## 6300

FEMALE BALL VALVE

Code	A	B	DN	ES	F	M	L	G	H	Pack.
6300-1/8	1/8	1/8	5.5	14-15	7.4	7.4	36	19	21	25
6300-1/4	1/4	1/4	5.5	14-15	11	11	43	19	21	25
6300-3/8	3/8	3/8	8	18-19	11.4	11.4	47	19	22	10
6300-1/2	1/2	1/2	10	22-23	15	15	59	26	30.5	10
6300-3/4	3/4	3/4	14	28-30	16.3	16.3	67	50	33	5

## 6310

MALE-FEMALE BALL VALVE

Code	A	B	DN	ES	F	M	L	G	H	Pack.
6310-1/8	1/8	1/8	5.5	14-15	7.4	7.4	36	19	21	25
6310-1/4-1/8	1/4	1/8	5.5	14-15	11	7.4	40.5	19	21	25
6310-1/4	1/4	1/4	5.5	14-15	11	11	43	19	21	25
6310-3/8	3/8	3/8	8	18-19	11.4	11.4	46	19	22	10
6310-1/2	1/2	1/2	10	22-23	15	15	57	26	30.5	10
6310-3/4	3/4	3/4	14	28-30	16.3	16.3	63	50	33	5

## 6068

GAS BALL VALVE - FEMALE-FEMALE

Code	A	DN	CH	L	G	H	Conf. Pack.
6068-1/2	1/2	15	25	46	75	47.5	10
6068-3/4	3/4	20	31	56.5	75	51	10
6068-1	1"	25	38	65.5	110	63	5
6068-1 1/4	1 1/4"	32	48	77	110	68.5	2
6068-1 1/2	1 1/2"	40	54	88.5	140	84.5	1
6068-2	2"	50	67	101.5	140	92.5	1

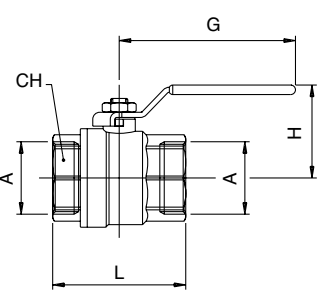
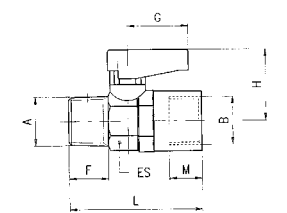
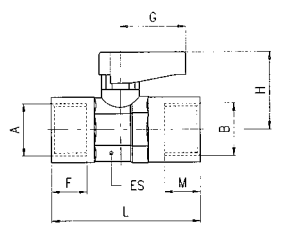
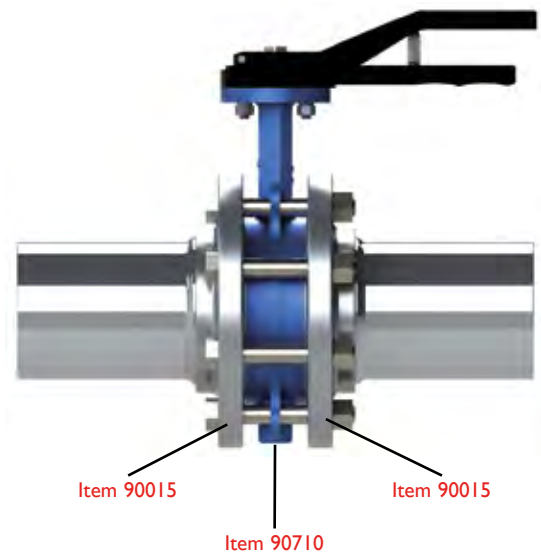
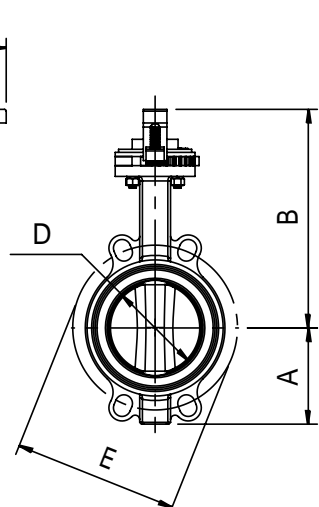
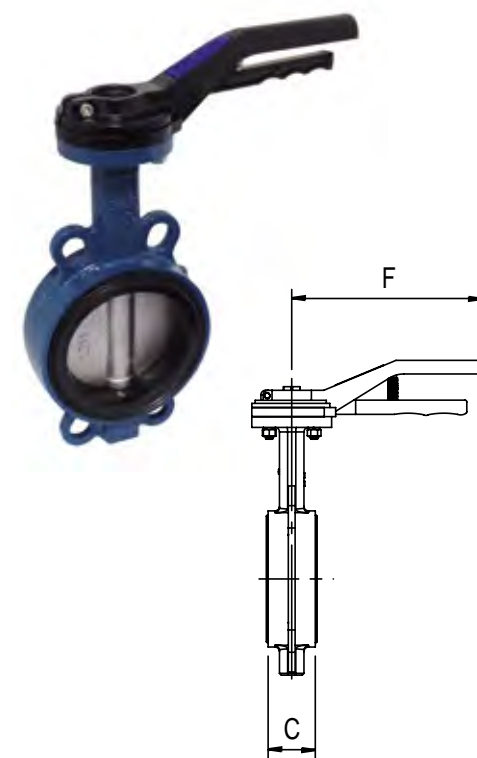
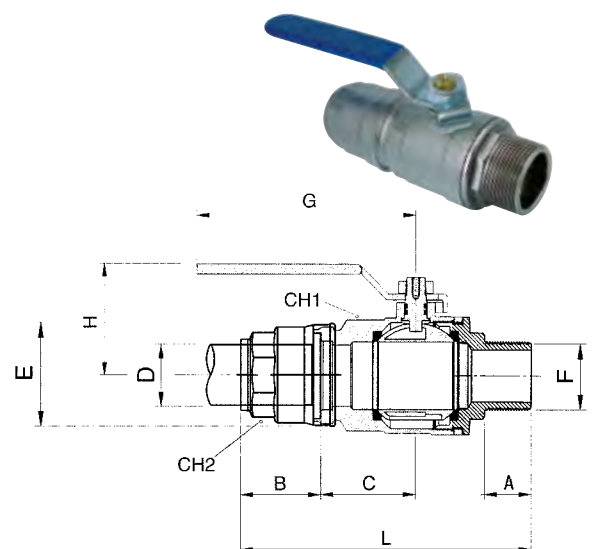
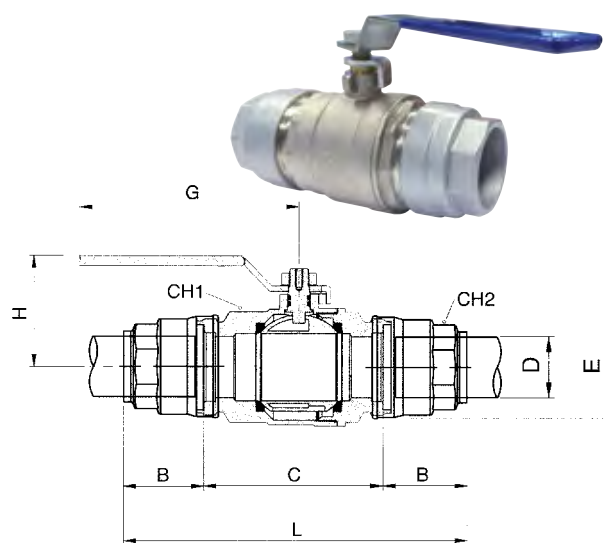
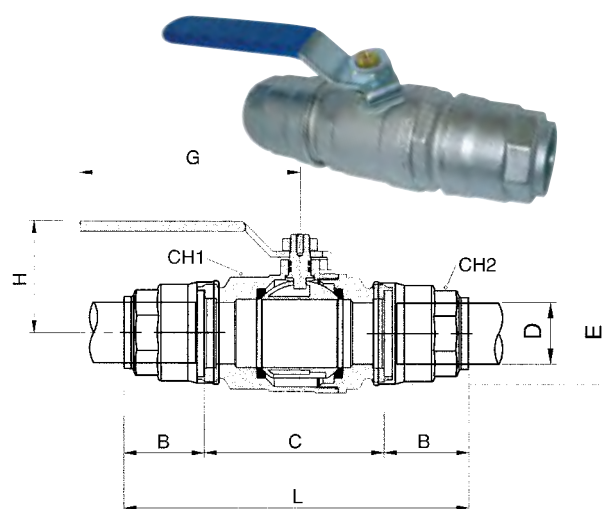

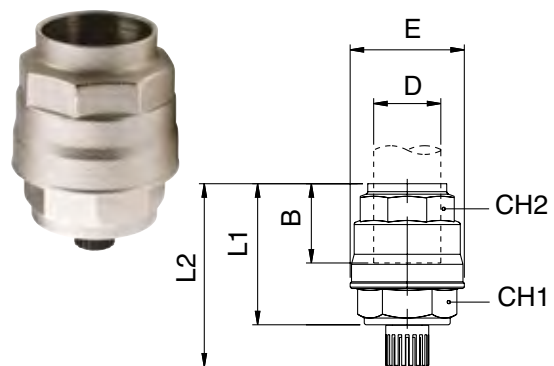

## 90260

CONDENSATE EXHAUST FOR DRIP LEG DRAIN

Code	D	B	E	L1	L2	CH1	CH2	Pack.
90260-20	20	36	34.5	52.5	67	32	30	2
90260-25	25	38.5	42.5	57.5	72	32	35	2
90260-32	32	46	52	67.5	82	38	45	2
90260-40	40	52	63	77	91.5	50	55	2
90260-50	50	63.5	73	86.5	101	55	65	1
90260-63	63	59	92	84	98.5	65	70	1

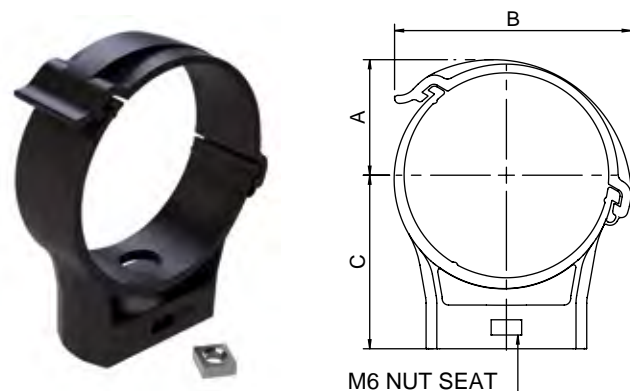

## 90815

PIPE CLIP TECHNOPOLYMERIC

Code	D	A	B	C	Pack.
90815-20	20	15	35.5	26	5
90815-25	25	17	39.5	26	5
90815-32	32	20	44.5	40	5
90815-40	40	24.5	53.5	40	5
90815-50	50	30	62	54	5
90815-63	63	36	73.5	54	5



## 90817

SPACER

Code	C	Pack.
90817	14	5



## 90820

RUBBER LINED METAL PIPE CLIPS

Code	D	H	A	Pack.
90820-20	20	M8 / M10	28.5	5
90820-25	25	M8 / M10	31	5
90820-32	32	M8 / M10	34.5	5
90820-40	40	M8 / M10	39.5	5
90820-50	50	M8 / M10	44	5
90820-63	63	M8 / M10	51	5
90820-80	80	M8 / M10	71	4
90820-110	110	M8 / M10	81.5	2

### PIPE CLAMP POSITIONS

4 MT.TUBE

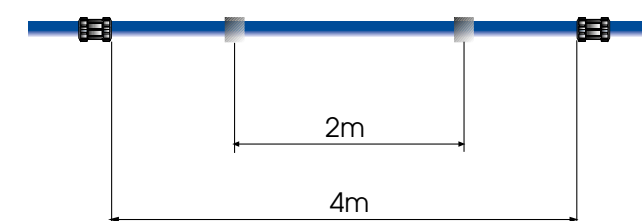

6 MT.TUBE

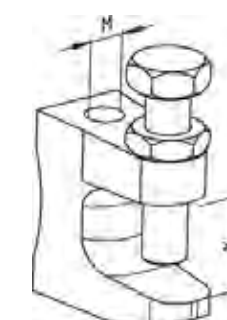
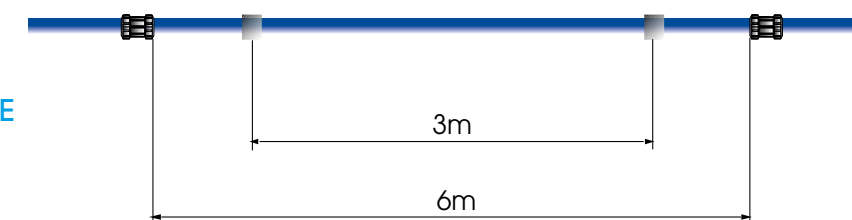

## 90860

GIRDER CLAMP

Code	M	K	Pack.
90860	Ø10mm	18	5

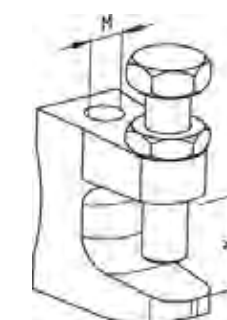

## 90861

GIRDER CLAMP

Code	M	K	Pack.
90861	M10	18	5

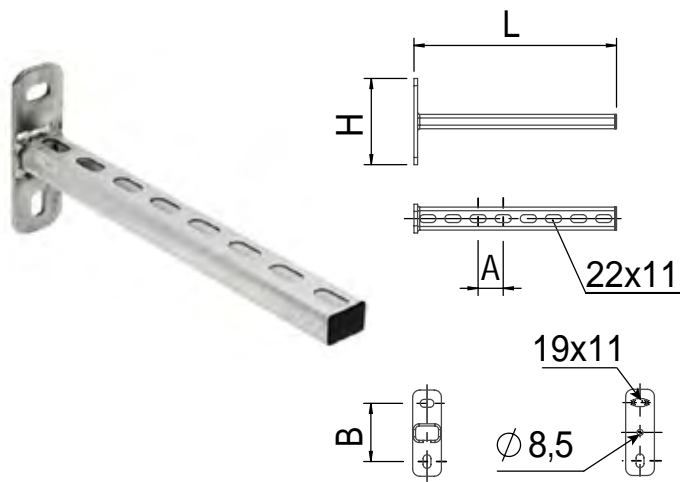

## 90830

BRACKET

Code	A	B	H	L	Pack.
90830	35	81	120	280	1

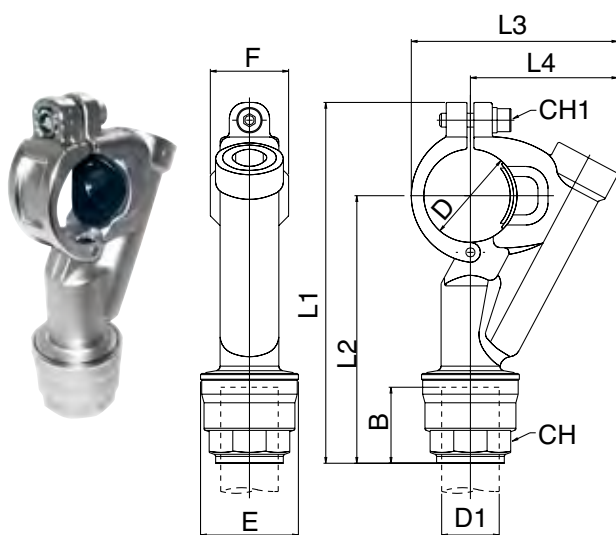

## 90240

SADDLE CLAMP CONNECTOR

Code	D	D1	B	E	F	L1	L2	L3	L4	CH	CH1	Pack.
90240-32-20	32	20	31.5	34.5	34	136.5	100.5	78	57	30	5	6
90240-32-25	32	25	38.5	42.5	34	144.5	108.5	78	57	35	5	6
90240-40-20	40	20	31.5	34.5	34	148.5	108	89.5	64	30	5	4
90240-40-25	40	25	38.5	42.5	34	156.5	116	89.5	64	35	5	4
90240-50-20	50	20	31.5	34.5	42.5	167.5	118.5	105.5	74	30	6	2
90240-50-25	50	25	38.5	42.5	42.5	175.5	126.5	105.5	74	35	6	1
90240-63-20	63	20	31.5	34.5	42.5	185	130	119	81	30	6	1
90240-63-25	63	25	38.5	42.5	42.5	193	138	119	81	35	6	1

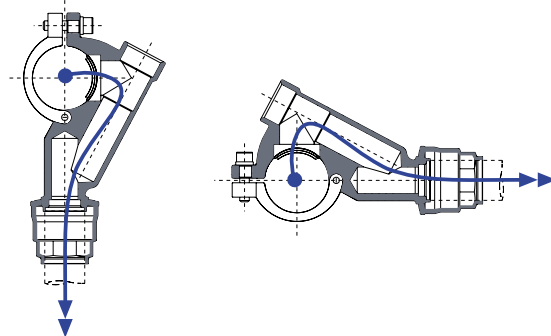

## 90241

TOOL FOR SADDLE CLAMP CONNECTOR

Code	Tube	C	D	D1	D2	L	L1	Pack.
90241-25	25	9	17.5	6	17	3	10	1
90241-32-40	32 40	9	24	6	23.5	3	10	1
90241-50-63	50 63	9	31	6	30.5	3	9	1

## 90242

DRILLING JIG 25MM - 63MM

Code	D	D1	F	L1	L2	L3	L4	CH	Pack.
90242-32	32	24.5	34	115	79	56	35	5	1
90242-40	40	24.5	34	127	86.5	65	39.5	5	1
90242-50	50	32	42.5	146	97	79	47.5	6	1
90242-63	63	32	42.5	163.5	108.5	93	55	6	1

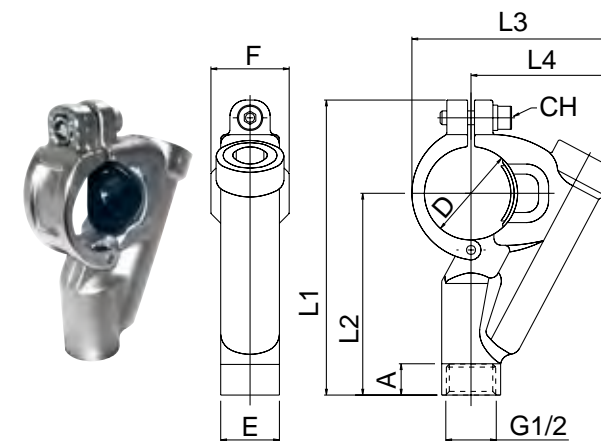

## 90246

SADDLE CLAMP X BSP OUTLET

Code	D		A	E	F	L1	L2	L3	L4	CH	Pack.
90246-32-1/2	32	1/2	13	25.5	34	115	79	78	57	5	2
90246-40-1/2	40	1/2	13	25.5	34	125.5	85	89.5	64	5	2
90246-50-1/2	50	1/2	13	25.5	42.5	144.5	95.5	105.5	74	6	2
90246-63-1/2	63	1/2	13	25.5	42.5	162	107	119	81	6	1

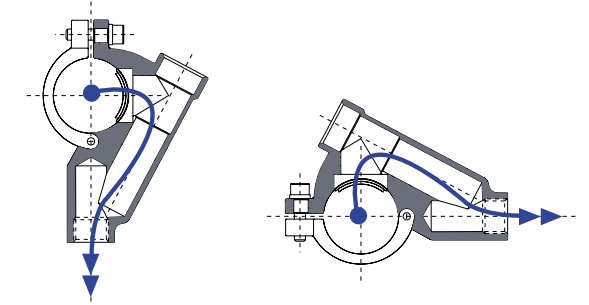

## 90247

SADDLE CLAMP X BSP OUTLET - NEW STYLE

Code	D		A	F	L1	L2	L3	CH	Pack.
90247-25-1/2	25	1/2	13	25.5	50	39	55.5	5	2
90247-32-1/2	32	1/2	13	34	63.5	42.5	61.5	5	2
90247-40-1/2	40	1/2	13	34	71	46	70	5	2
90247-50-1/2	50	1/2	13	42.5	83.5	52	84.5	6	2
90247-63-1/2	63	1/2	13	42.5	95.5	57.5	97	6	2

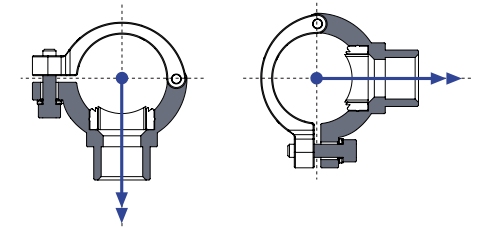

## 90247-80-110

FEMALE SADDLE CLAMP CONNECTOR

Code	D	B	A	F	L1	L2	L3	CH	Pack.
90247-80-3/4	80	3/4	16.5	50	117.5	66.5	141.5	6	1
90247-80-1	80	1"	19	50	120	69	141.5	6	1
90247-110-3/4	110	3/4	16.5	50	152.5	82	189.5	8	1
90247-110-1	110	1"	19	50	155	84.5	189.5	8	1

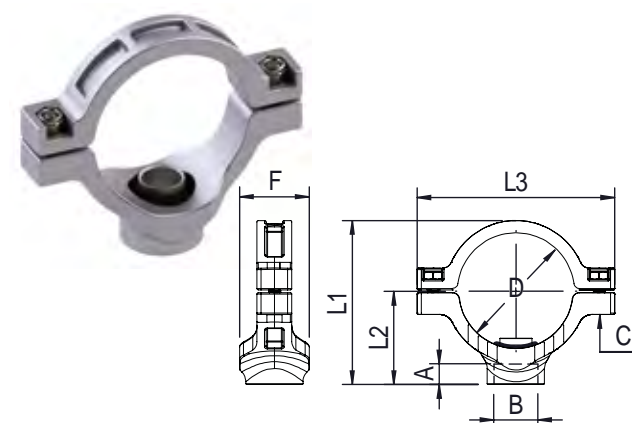
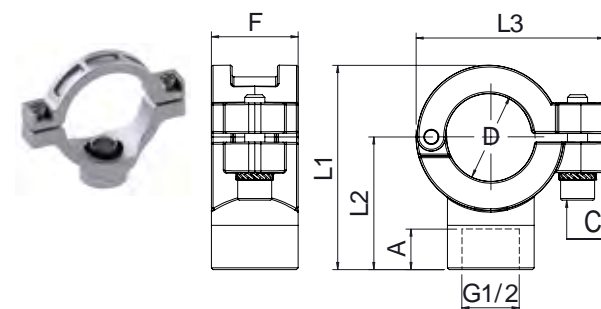
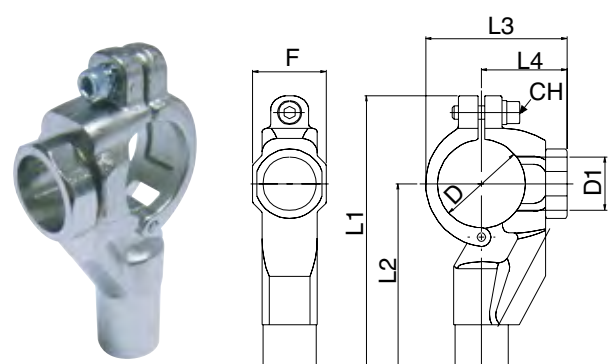
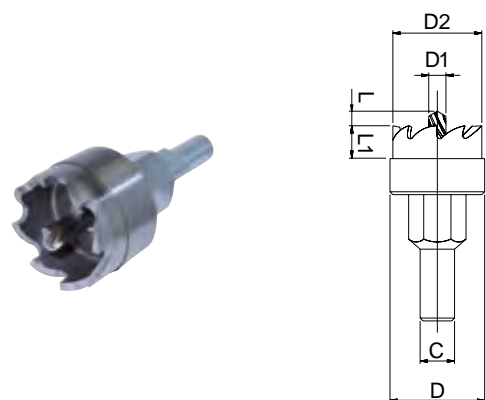
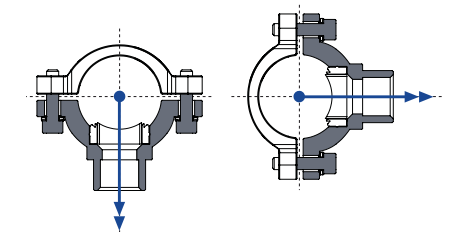



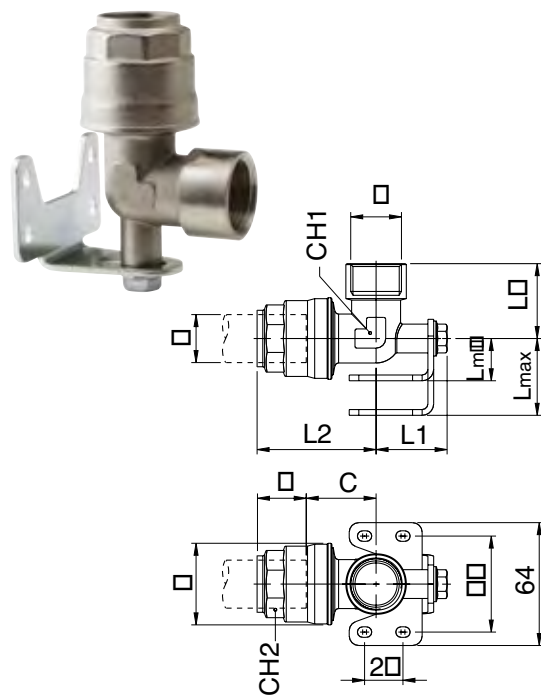

## 90600

BRACKET FITTING - SINGLE OUTLET

Code	D	F	B	C	E	L1	L2	L3	Lmax	Lmin	CH1	CH2	Pack
90600-20-1/2	20	1/2	31.5	19.5	34.5	35	51	35	40	22	21	30	4
90600-25-3/4	25	3/4	38.5	23	42.5	37	62	39	40	22	26	35	3
90600-32-1	32	1"	46	28	52	41	74.5	48.5	40	26	34	45	2

ADJUSTABLE

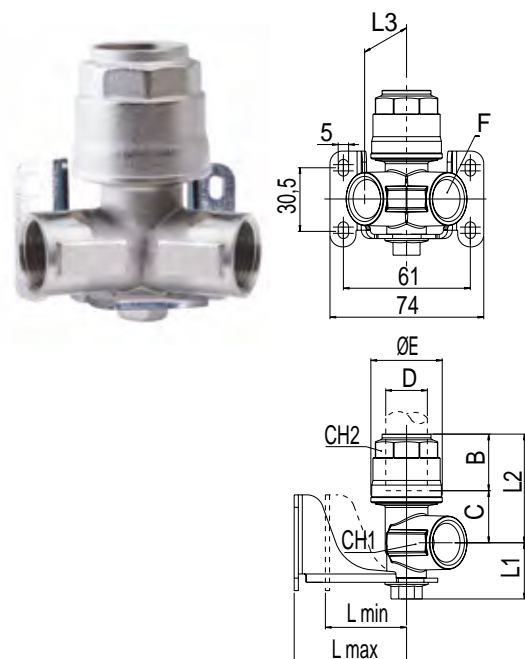

## 90602

BRACKET FITTING - DOUBLE OUTLET

Code	D	F	B	C	E	I	L1	L2	Lmin	Lmax	CH1	CH2	Pack
90602-20-1/2	20	1/2	31.5	20	34.5	28.5	27	51.5	22	54	26	30	2
90602-25-1/2	25	1/2	38.5	21	42.5	28.5	27	59	22	54	26	35	2

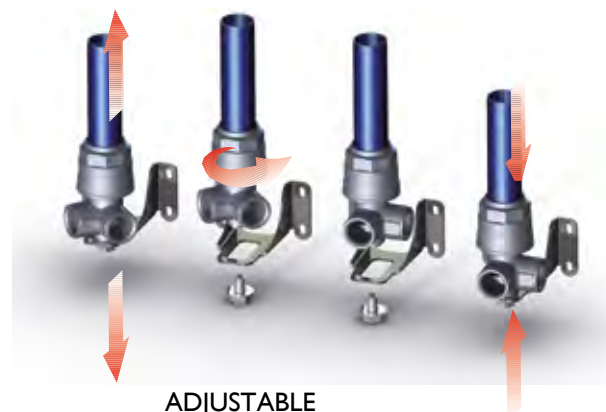

ADJUSTABLE

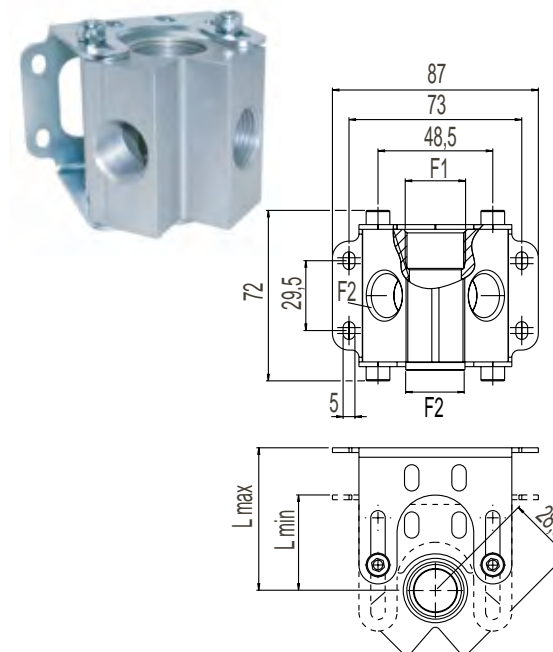

## 90642

2 WAYS MANIFOLD

Code	F1	F2	n°	Lmax	Lmin	Pack
90642-1/2-1/2-2	1/2	1/2	2	60	35	1
90642-3/4-1/2-2	3/4	1/2	2	60	35	1

### Applications example

